

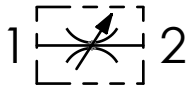

Hydraulic circuit



01

02

Ordering code

VBRF

01	Bidirectional flow control valves	VBRF	
02	Size	BSPP 1/8	180
		BSPP 1/4	140
		BSPP 3/8	380
		BSPP 1/2	120
		BSPP 3/4	340
		BSPP 1	100
		BSPP 1-1/4	114

Technical data

Mineral oil	ISO 6743/4 (DIN 51524)	
Oil viscosity	15-250 mm ² /s (15 to 250 cSt)	
Max contamination index with filter	ISO 4406:1999 Classe 19/17/14	
Oil temperature	-20°C +80°C	-4°F + 176°F
Ambient temperature	-20°C +50°C	-4°F + 122°F

It is necessary a filter use to protect the valve (advised filtration 15 µm)

Performances

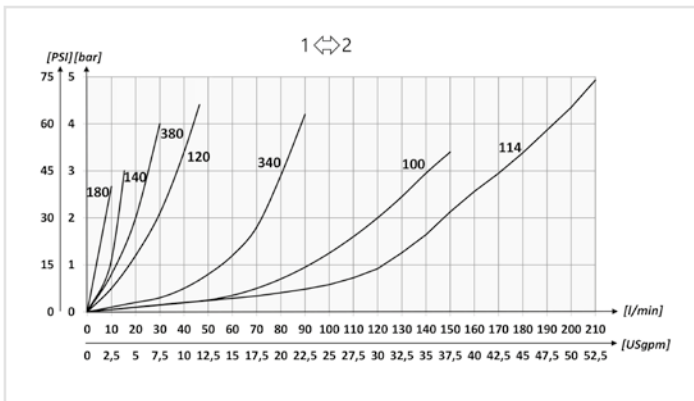

Technical characteristics

Type	A	Max flow l/min-USgpm	Max pressure bar/PSI	B	L	Approx weight kg/lb	
VBRF180 BSPP 1/8		5 (1,3)	350 (5075)	25 (0.98)	48 (1.89)	0,12 (0.26)	
VBRF140 BSPP 1/4		15 (4)		34 (1.34)	62 (2.44)	0,28 (0.6)	
VBRF380 BSPP 3/8		30 (7.9)		39 (1.54)	73 (2.87)	0,45 (1)	
VBRF120 BSPP 1/2		45 (11.9)		44 (1.73)	83 (3.27)	0,63 (1.4)	
VBRF340 BSPP 3/4		85 (22.4)		300 (4350)	54 (2.13)	102 (4.02)	1,06 (2.33)
VBRF100 BSPP 1		150 (39.6)		250 (3625)	65 (2.56)	124,5 (4.90)	1,8 (4)
VBRF114 BSPP 1-1/4		200 (52.8)			75 (2.95)	144 (5.67)	2,78 (5.96)

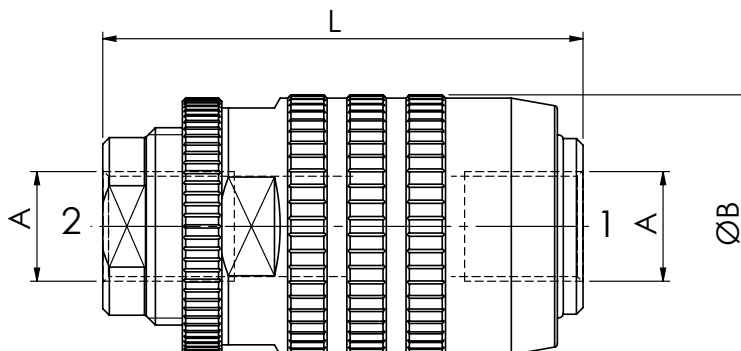

[mm
(Inches)]